

User Menu for Hoymiles APP Monitoring Platform Rev 3.0

No 1 Content introduction

Step 1. App login interface.

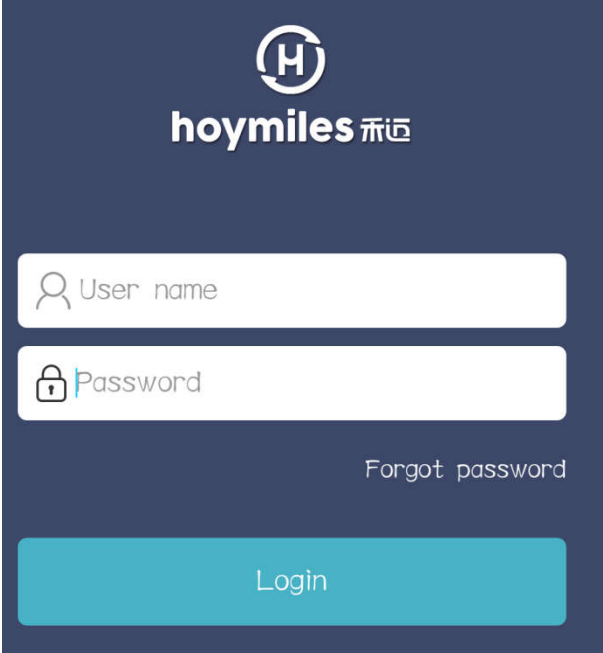

hoymiles 禾迈

User name

Password

[Forgot password](#)

Login

Step 2. Input the account and password and click log in.

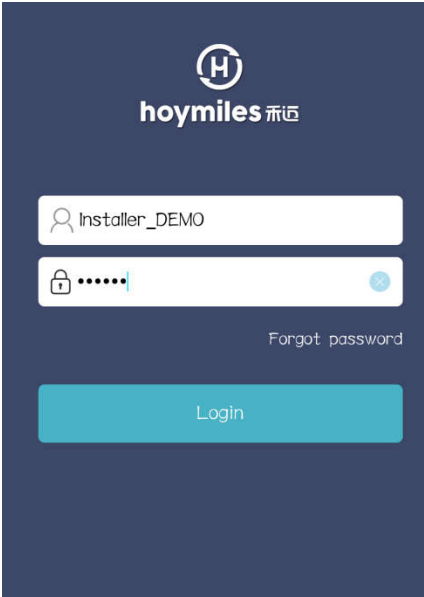

hoymiles 禾迈

Installer_DEMO

.....

[Forgot password](#)

Login

Step 3. Power station homepage.

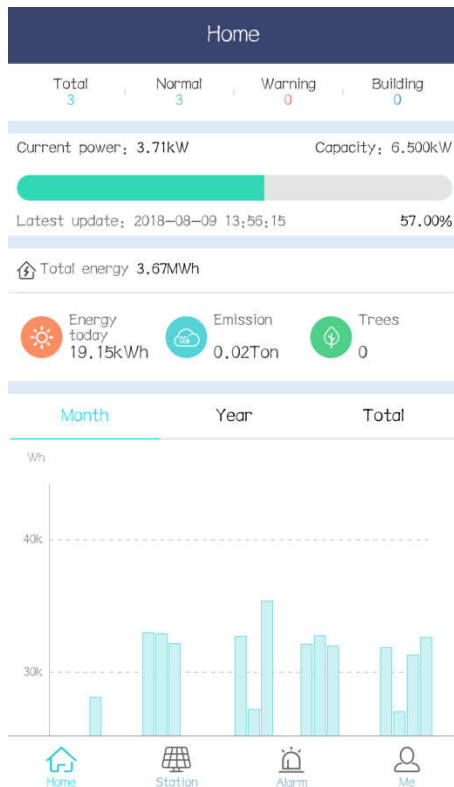

Step 4. Click “Total”, you will see station list.

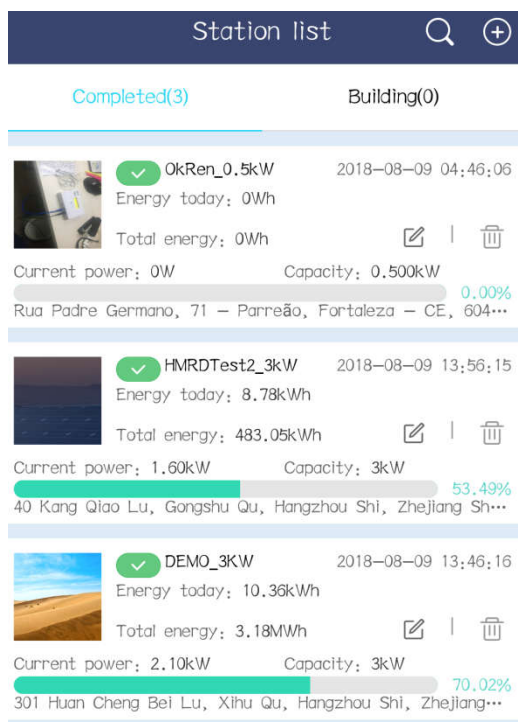

Step 5. Click“HMRDTest2-3kw”, you will see the power station information.

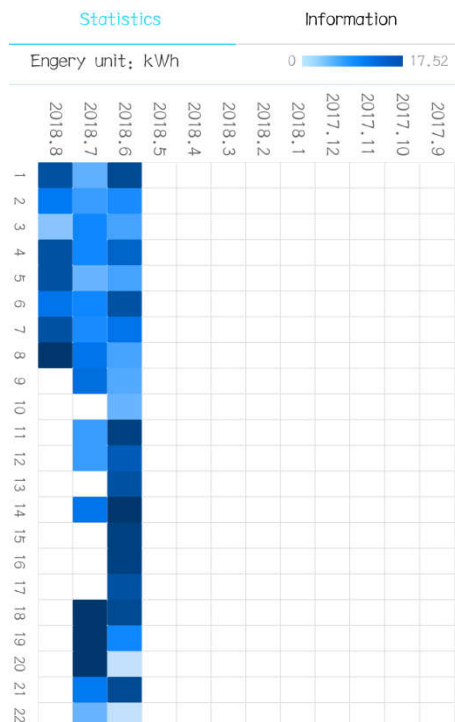

Click Information → Edit, you can edit owner information

Statistics Information

First name 林
Last name 陈
Phone ---
Email ---

Station HMRDTest2_3kW
Address 40 Kang Qiao Lu, Gongshu Qu, Hangzhou Shi, Zhejiang Sheng, China
Grid type Distributed full Internet access
Time zone (UTC+08:00) Beijing,Chongqing,Hong Kong,Urumqi

Capacity 3.0kW
Installation time 2018-05-31 14:11:56
Installer information 17600000000

Edit

Step 6. Click , you can edit module layout.

Untie position

Delete module

Cancel

Continue binding

MI entry and layout

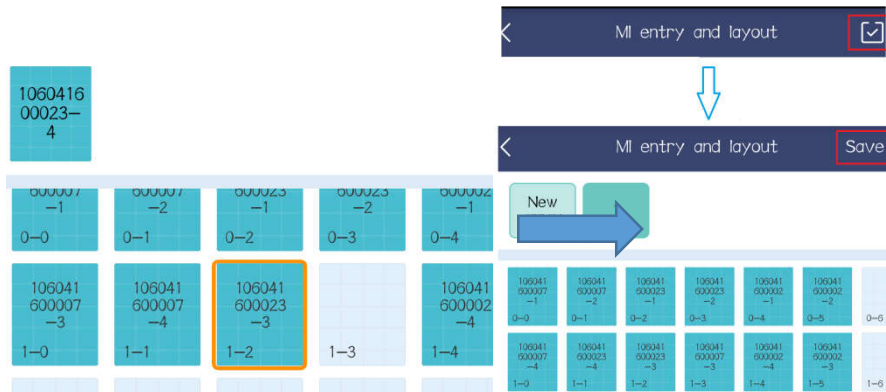

Step 7. Click , you can operate device(replace,delete...)

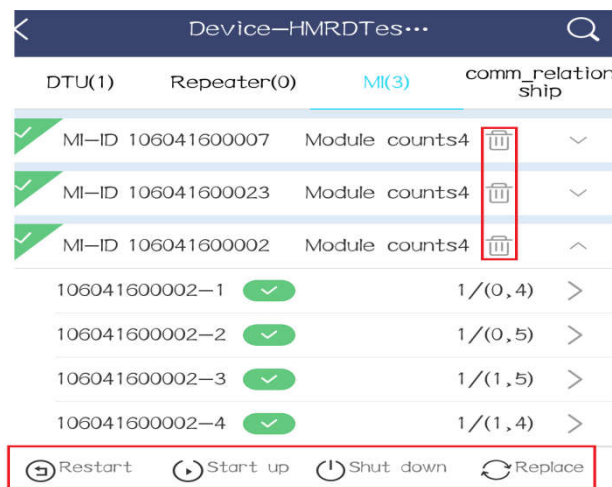

No 2 Upload the picture of power station

Step 1. Click the  button.

 ✓ HMRDTest2_3kW 2018-08-09 16:41:15
Energy today: 11.47kWh
Total energy: 485.74kWh  
Current power: 601.20W Capacity: 3kW
 20.04%
40 Kang Qiao Lu, Gongshu Qu, Hangzhou Shi, Zhejiang Sh...

Step 2. Click the 1 and 2 buttons in turn.

Information

- *Capacity(kW) 3.0 
- *StationName HMRDTest2_3kW
- *Station typeHome Roof >
- *Grid type Distributed full Internet access >
- *Time zone (UTC+08:00) Beijing,Chongqing,Hon... >
- *Address 40 Kang Qiao Lu, Gongshu Qu, Hangzhou Shi, Zhejiang Sheng, China 

Detail address Complement the selected address

Upload station photo



Please upload images with jpg, png, bmp in 5M format

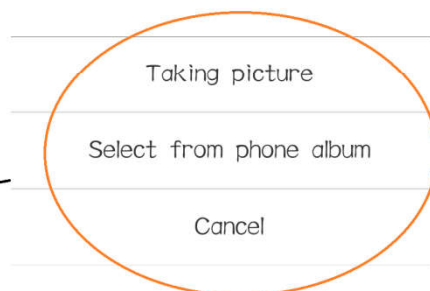

2

No 3 Change the languages

Step 1. Click the 1 and 2 buttons in turn.

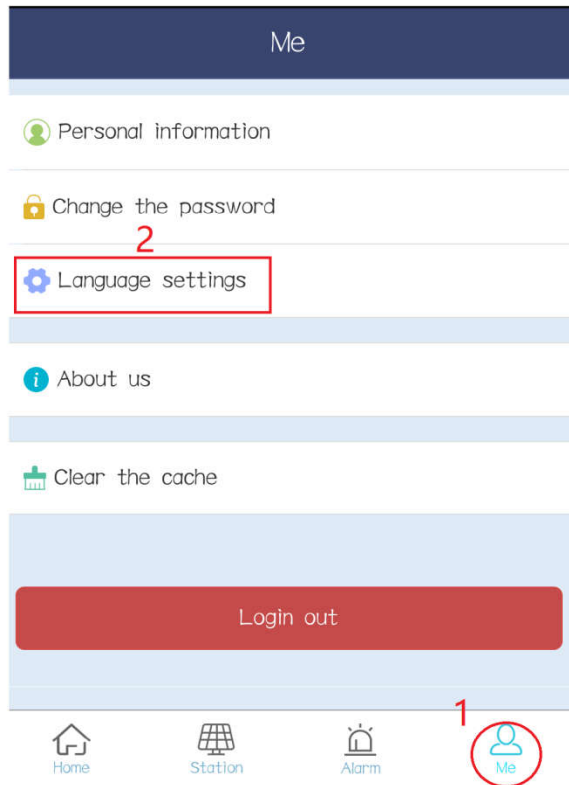

Step 2. Set the language you want.

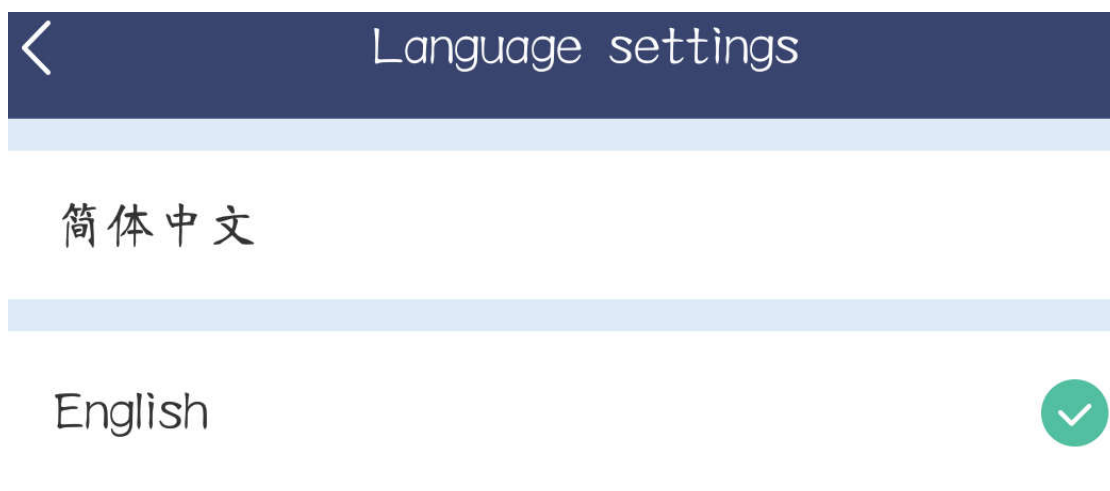

No 4 Change the password

Step 1. Click the 1 and 2 buttons in turn.

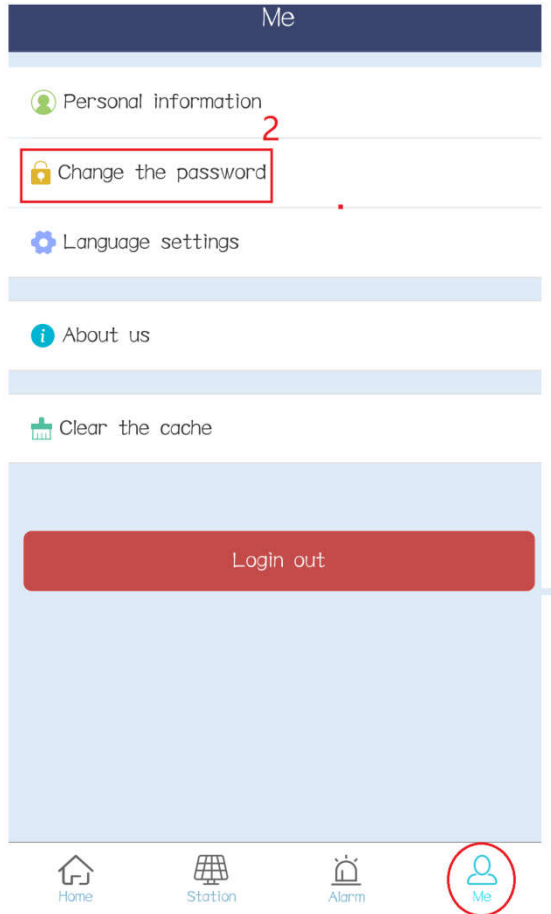

Step 2. Set new password.

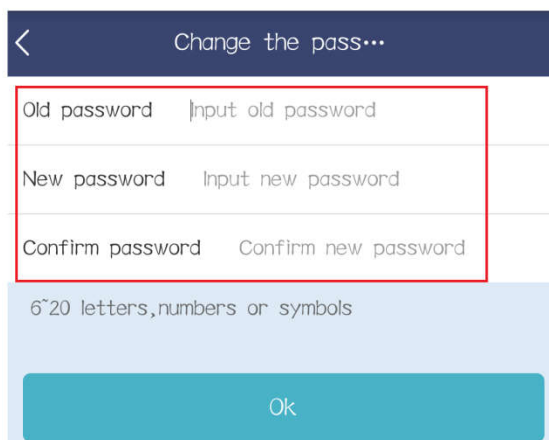

No 5 upgrade APP version

Step 1. Click the 1 and 2 buttons in turn.

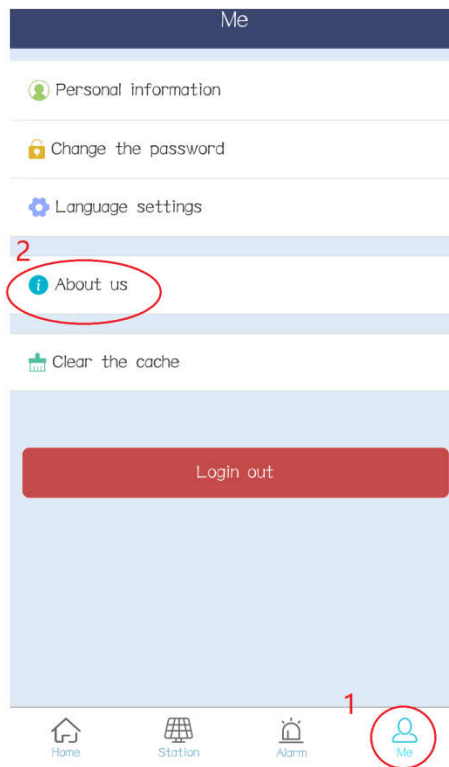

Step 2. Click “Check update” and update it.

